

# CONVERSION PKG - BC14B

The KIT-B Conversion Package “BC14B” includes all the components of **Device #9** to meet current Chlorine Institute specifications.

## PART# BC14B

### CONVERSION PACKAGE INCLUDES:

- (1) Yoke 9B
- (1) Cap Screw 9C1
- (1) Patch 9D1
- (1) Strap 9S
- (2) Gaskets 9GV
- (2) Instruction Book



### CAP SCREW 9C1 (Replacing Cap Screw 9C)

- Designed to be “hand tightened” but accessible with the standard valve wrench as well.

### PATCH 9D1 (Replacing Patch 9D)

- Needs one-third the torque of former patch design.
- Includes two adjusting screws for applying additional targeted pressure.

### GASKET 9GV (Replacing Gasket 9EV)

- Molded to fit into Patch 9D1.
- Designed to seal small sidewall leaks with less pressure on cylinder wall.

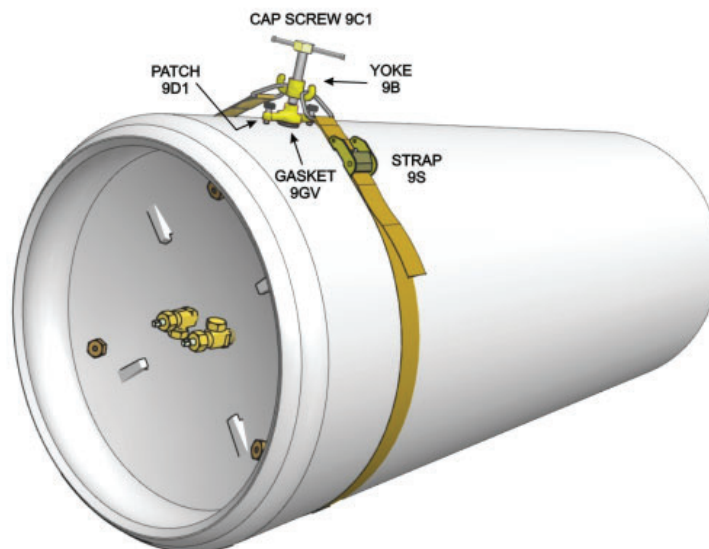
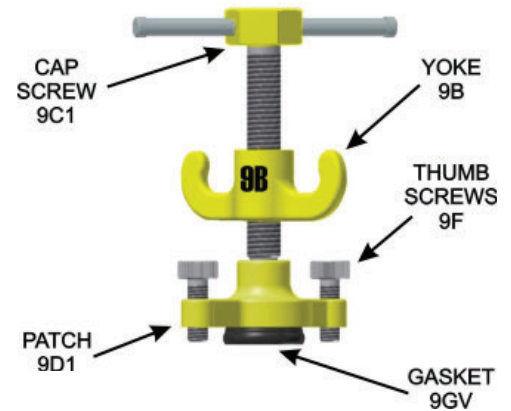

1 Carton 10" x 10" x 8", 6 lbs.

# INDIANSPRINGS

Indian Springs Manufacturing Co., Inc. PO Box 469 Baldwinsville NY 13027-0469. (315) 635-6101  
www.indiansprings.com